

Drawings: P:\1911-001\CADD\dwg\working_drawings\submitter\BIGGS RD\1911-001.TC - BIGGS.dwg
 User: CDJAKK Oct 26, 20 - 10:59
 Plot Date/Time: Jan 06, 21 - 12:08:57

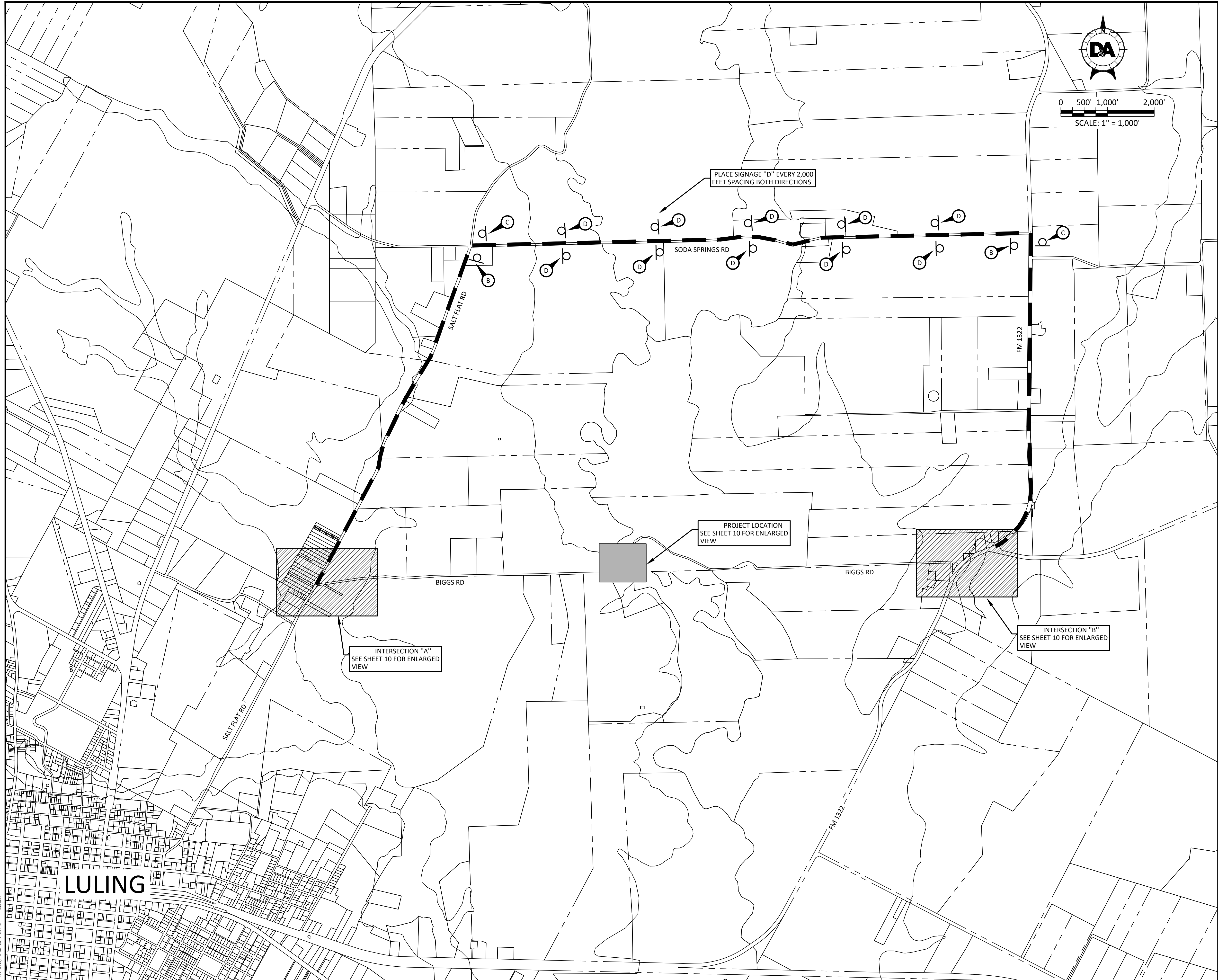

CONTRACTOR NOTES:
 EXISTING UNDERGROUND & OVERHEAD UTILITIES IN VICINITY. CONTRACTOR TO CONTACT UTILITY COMPANIES PRIOR TO CONSTRUCTION. CONTRACTOR TO CALL 811 FOR UTILITY LOCATES PRIOR TO EXCAVATION. CONTRACTOR TO FIELD VERIFY EXISTING UTILITY LOCATIONS & DEPTH PRIOR TO BEGINNING CONSTRUCTION.
 CONTRACTOR SHALL CONSIDER PROPOSED UTILITY IMPROVEMENTS AND PROVIDE ADEQUATE HORIZONTAL AND VERTICAL CLEARANCE DURING INSTALLATION OF ALL UTILITY INFRASTRUCTURE.

LEGEND

	DETOUR ROUTE
	DETOUR TRAFFIC FLOW
	SIGNAGE LOCATION
	MESSAGE BOARD
	M4-9N 30"x12" M4-9AR 30"x30"
	M4-9N 30"x12" M4-9AL 30"x30"
	M4-9N 30"x12" M4-9S 30"x24"
	C3RDXD 48"x48"
	M4-9N 30"x12"
	R11-2 48"x30"
	R11-4 60"x30"
	M4-8a 24"x18"
	R5-12 18"x24"
	CW10-11 48"x48"
	PCTB OR WATER-FILLED BARRICADE

*SEE TXDOT STD. DETAIL WZ (RCD) - 13 FOR PLACEMENT GUIDELINES

D&A DOUCET & ASSOCIATES
 Civil Engineering - Planning - Geospatial
 7401 B. Highway 71 W, Suite 140
 Austin, TX 78735, Tel: (512)-583-2600
 www.doucetengineers.com
 TBPE Firm Number: 3937
 TBPLS Firm Number: 10106800

DETOUR ROUTE PLAN

**BIGGS ROAD
 CALDWELL COUNTY, TEXAS**

THIS DOCUMENT IS RELEASED FOR THE PURPOSE OF INTERIM REVIEW UNDER THE AUTHORITY OF COLIN SLAGLE, P.E. #110306 ON 1/6/2021. IT IS NOT TO BE USED FOR PERMITTING, BIDDING, OR CONSTRUCTION PURPOSES.



1-6-21
 Designed: CS
 Drawn: ZD
 Reviewed: TB
 Date: 1/6/2021

SHEET
9
 OF 17
 Project No.: (P) 1911-001



Drawing: F:\1911-001\CADD\wg\working_drawings\submittal\BIGGS RD\1911-001.TC - BIGGS.dwg
 User: CDJDKK
 Date: 06/21/21 - 10:53
 Plot Date/Time: 06/21/21 - 12:09:09

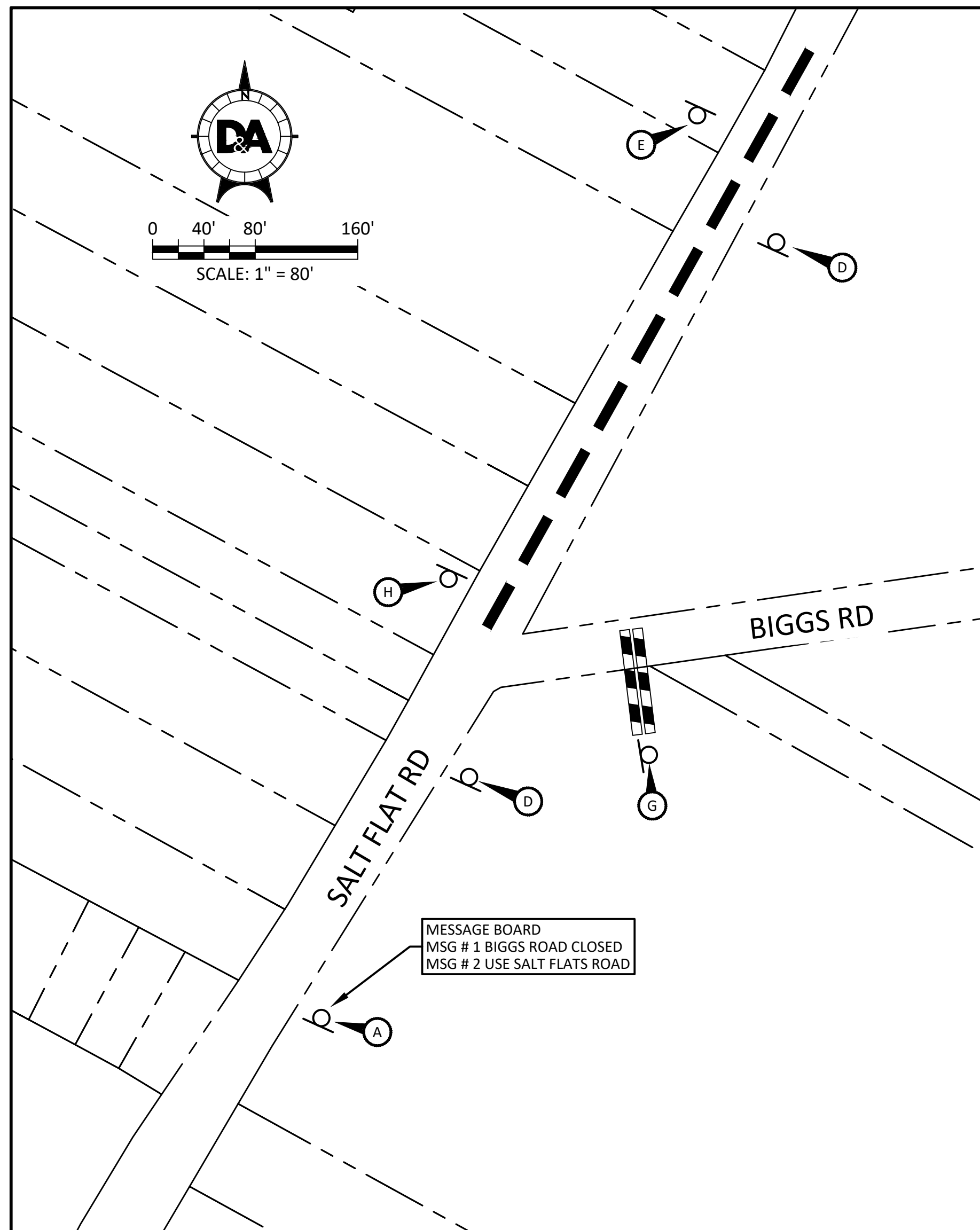

INTERSECTION "A"
SCALE: 1" = 80'

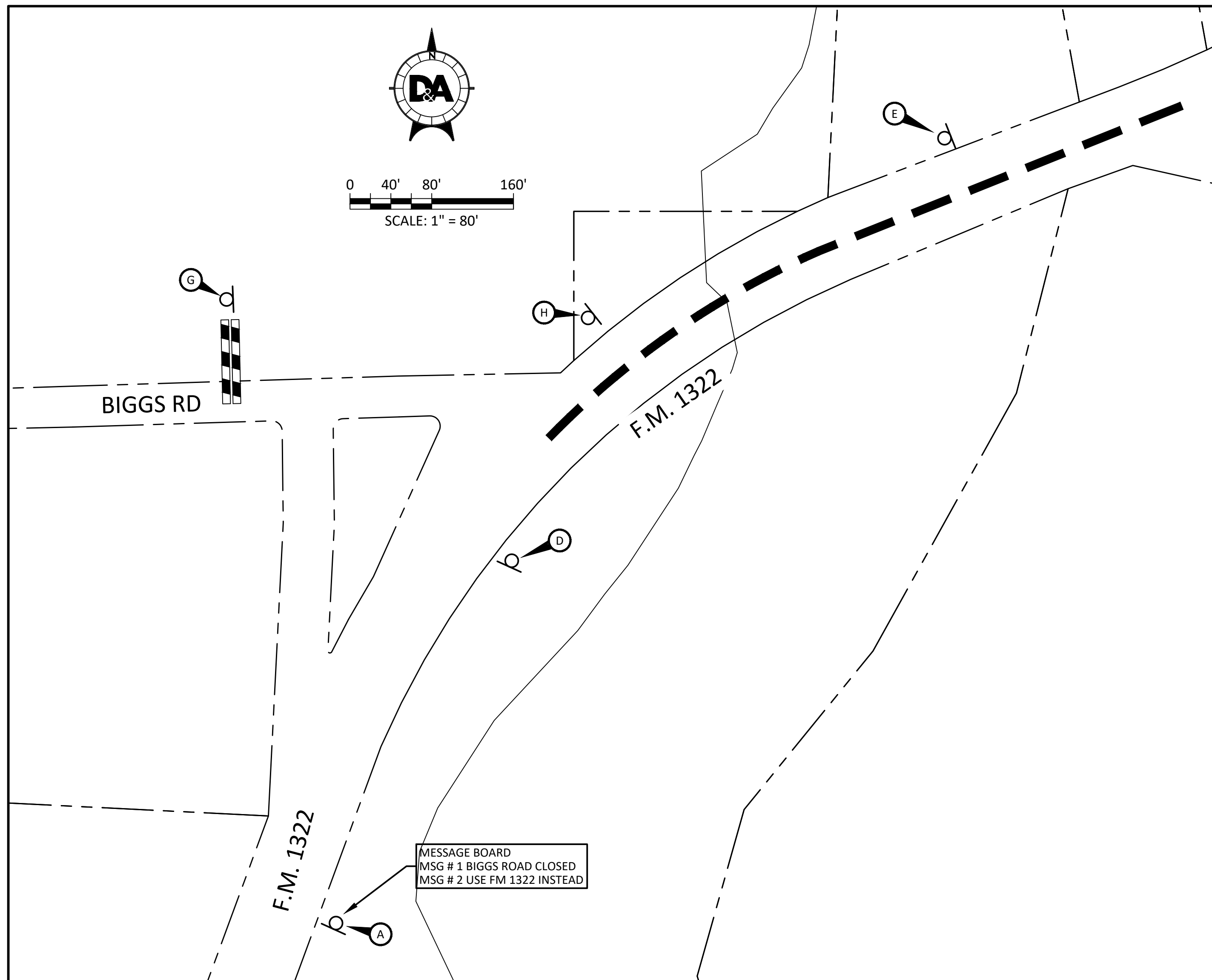

INTERSECTION "B"
SCALE: 1" = 80'

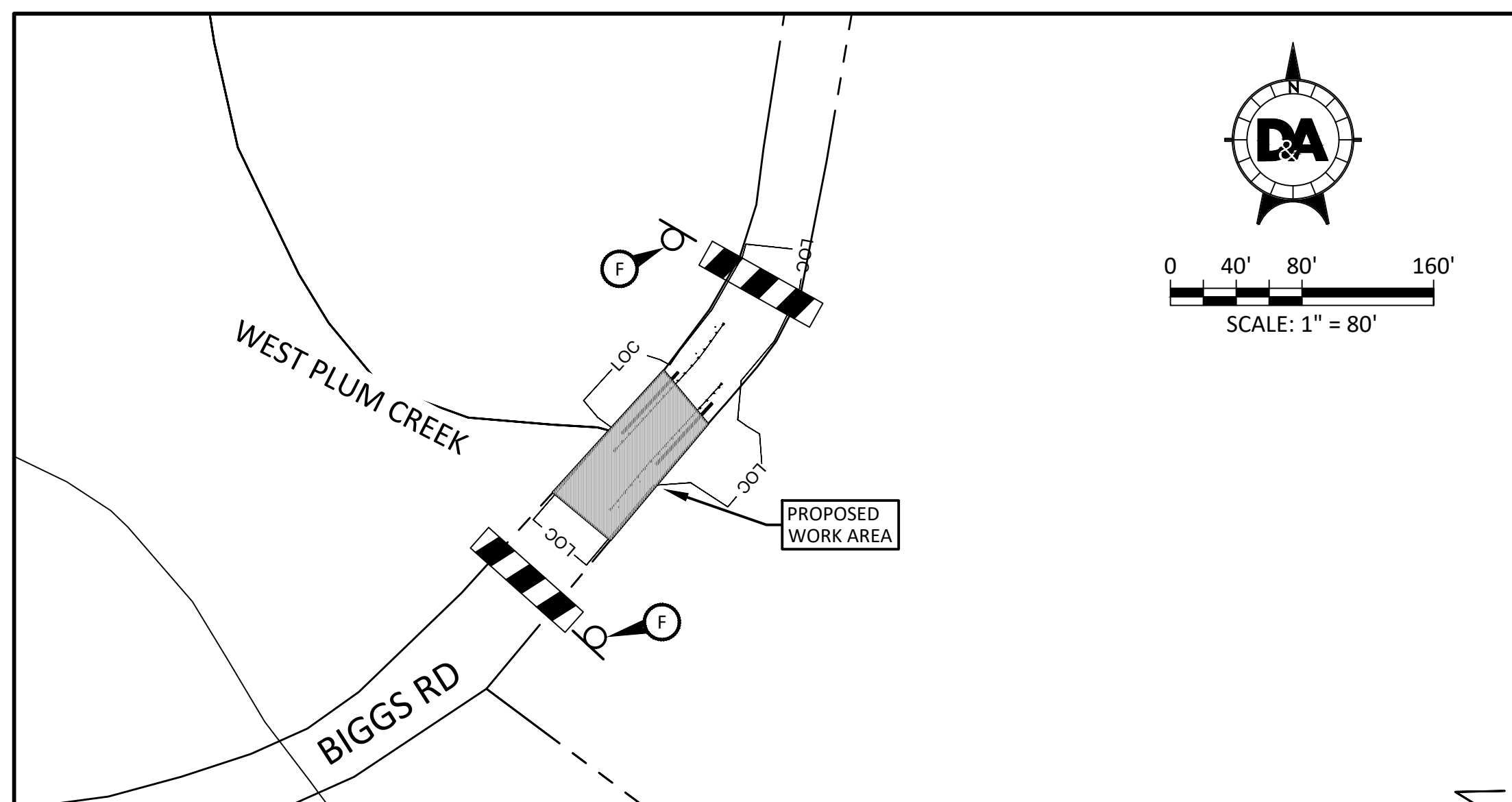

PROJECT SITE
SCALE: 1" = 80'

CONTRACTOR NOTES:
 EXISTING UNDERGROUND & OVERHEAD UTILITIES IN VICINITY. CONTRACTOR TO CONTACT UTILITY COMPANIES PRIOR TO CONSTRUCTION. CONTRACTOR TO CALL 811 FOR UTILITY LOCATES PRIOR TO EXCAVATION. CONTRACTOR TO FIELD VERIFY EXISTING UTILITY LOCATIONS & DEPTH PRIOR TO BEGINNING CONSTRUCTION.
 CONTRACTOR SHALL CONSIDER PROPOSED UTILITY IMPROVEMENTS AND PROVIDE ADEQUATE HORIZONTAL AND VERTICAL CLEARANCE DURING INSTALLATION OF ALL UTILITY INFRASTRUCTURE.

LEGEND	
	DETOUR ROUTE
	DETOUR TRAFFIC FLOW
	SIGNAGE LOCATION
	MESSAGE BOARD
	M4-9N 30"x12" M4-9AR 30"x30"
	M4-9N 30"x12" M4-9AL 30"x30"
	M4-9N 30"x12" M4-9S 30"x24"
	C3RDXD 48"x48"
	M4-9N 30"x12" ROAD CLOSED R11-2 48"x30"
	ROAD CLOSED TO THRU TRAFFIC R11-4 60"x30"
	END DETOUR M4-8a 24"x18"
	NO THRU TRUCKS R5-12 18"x24"
	CW10-11 48"x48"
	PCTB OR WATER-FILLED BARRICADE
	TY III BARRICADE

*SEE TXDOT STD. DETAIL WZ (RCD) - 13 FOR PLACEMENT GUIDELINES

DA DOUCET & ASSOCIATES
 Civil Engineering - Planning - Geospatial
 7401 B. Highway 71 W, Suite 140
 Austin, TX 78735, Tel: (512)-583-2600
 www.doucetengineers.com
 TSP# Firm Number: 3937
 TPLS Firm Number: 10106800

DETOUR INTERSECTION PLAN

BIGGS ROAD, TEXAS
CALDWELL COUNTY, TEXAS

THIS DOCUMENT IS RELEASED FOR THE PURPOSE OF INTERIM REVIEW UNDER THE AUTHORITY OF COLIN SLAGLE, P.E. #110306 ON 1/6/2021. IT IS NOT TO BE USED FOR PERMITTING, BIDDING, OR CONSTRUCTION PURPOSES.

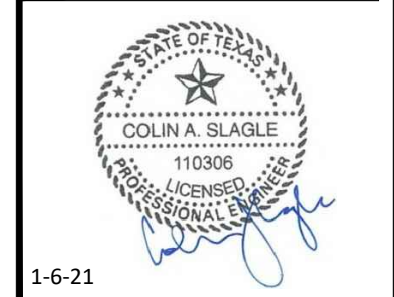

1-6-21
 Designed: CS
 Drawn: ZD
 Reviewed: TB
 Date: 1/6/2021

